

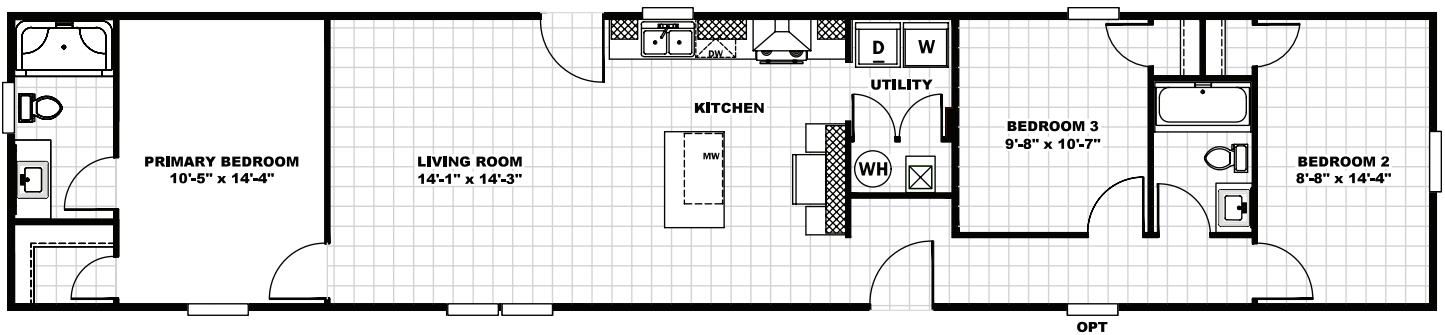

AUGUSTA

3 beds | 2 baths | 1,080 sq. ft. | 16x72



Standard Features

EXTERIOR / CONSTRUCTION

- Vinyl Siding
- Thermoply Underlayment
- 2x4 Exterior Walls - 16" On-Center
- 8ft Ceilings (Stipple Finish)
- No Dormer
- Cement Board Fascia w. Vented Vinyl Soffit
- Low-E Windows (White)
- 2 Panel Vinyl Shutters Front Door Side
- 36x80" 6-Panel Front Door (No Storm)
- 36x80" 9-Lite Rear Door (In-Swing)
- Vinyl Corner Posts (White)

FLOORS

- 2x6 Transverse Floor Joists - 16" On-Center
- "Pier-Saver" Construction all Exterior Doors
- 19/32" Tongue & Groove OSB Floor Decking
- One-Piece Aluminum Floor Ducts
- 25oz Carpet - Primary Bedroom Only
- Vinyl Flooring - All Other Areas

MISCELLANEOUS

- 1 Piece Fiberglass Shower
- No Backsplash
- 2-Panel Square Interior Doors
- Shelving in all Closets & Utility Room
- eBuilt® Construction
- Single Square Ceramic Sink
- ecobee Smart Thermostat®
- SmartComfort® by Carrier®

KITCHEN

- DuraCraft® Cabinetry (42" Overhead - Finished)
- European Hidden Hinges
- Knobs on all Doors (Black)
- Pulls on all Drawers (Black)
- 1 Bank of Drawers
- No Pot & Pan Drawers
- Samsung® Stainless Steel Appliances
 - 18 Cu. Ft. Top-Mount Refrigerator with Icemaker
 - Smooth-Top Electric Range
 - Stainless Steel Range Hood
- Pfister® Faucets

PLUMBING & ELECTRICAL

- Whole House Water Cut-Off
- Water Cut-Offs at All Fixtures
- 40 Gallon Hybrid Heat Pump Water Heater
- LED Can Lighting Thru-Out
- 200 AMP Electrical Service
- Exterior Outlet on Rear
- Frost Free Faucet on Rear

Popular Options

- | | | |
|--|---|---|
| <input type="checkbox"/> OSB Wrap | <input type="checkbox"/> Stainless Side-by-Side Refrigerator | <input type="checkbox"/> Cage Light @ Kitchen Island |
| <input type="checkbox"/> Dormer | <input type="checkbox"/> Dishwasher | <input type="checkbox"/> Farm House Kitchen Sink (Stainless or White) |
| <input type="checkbox"/> Columns @ Dormer | <input type="checkbox"/> 4" Backsplash (Kitchen & Vanities) | <input type="checkbox"/> EZ Close Up |
| <input type="checkbox"/> Vertical Board & Batten between Columns | <input type="checkbox"/> 2 Pot & Pan Drawers in Kitchen | <input type="checkbox"/> Library Accent Wall |
| <input type="checkbox"/> Shake between Columns | <input type="checkbox"/> Glamour Bath | <input type="checkbox"/> 2" Mini-Blinds Through-Out Home |
| <input type="checkbox"/> Craftsman Front Door (White or Black) | <input type="checkbox"/> Hand-laid Tile Showers (48", 60", 72" where available) | <input type="checkbox"/> Wire & Brace for Ceiling Fan |
| <input type="checkbox"/> Full View Storm (Front and/or Rear) - Shipped loose | <input type="checkbox"/> Dark Mode Exterior Package | <input type="checkbox"/> Hinged Barn Door (Pantry or Utility) |
| <input type="checkbox"/> Bronze Windows | <input type="checkbox"/> Midnight Hardware Package | <input type="checkbox"/> 50 Gallon Hybrid Heat Pump Water Heater |
| <input type="checkbox"/> 2x6 Exterior Walls 16" On-Center (w. R-21 Insulation) | <input type="checkbox"/> Midnight Plumbing Package | <input type="checkbox"/> Carpet in Bedrooms |
| | <input type="checkbox"/> Built-In Microwave w. 2 Pot & Pan Drawers | <input type="checkbox"/> Double Sinks @ Vanity (where available) |

Customer Name: _____

Customer Signature: _____

Phone Number: _____

County: _____

CSM: _____

****All Options Subject to Change Without Notice****

The home series, floor plans, photos, renderings, specifications, features, pricing, materials and availability shown will vary by retailer and state, and are subject to change without notice.



claytongiles.com
405 S. Broad St, New Tazewell, TN 37825

